



ABE_300 CHILLER FOR BIOGAS ANALISYS

PRESENTATION





KEY FEATURES

Refrigerator for the first treatment of landfill gas (removal of water vapor by cooling in continuous sample). The gas sample must be sent into the entrance of the fridge named "GAS", from here through a circuit dedicated to the processing circuit (stainless steel), stabilized at a constant temperature (maximum deviation 0.1 °C) set in the configuration (setting Factory 2 degrees Celsius).

Thanks to the cooling water vapor condenses and is separated from the gas is collected in a tank and ejected in the form of condensation using peristaltic pump. The process gas leaves from the exit "GAS OUT".

The chiller can operate either in depression, or under pressure

ABE_300 Chiller for biogas. The ABE_300 is used for:

- Cooling of the sample gas.
- Separation by condensation, by lowering the temperature of the gas at 2 ° C.
- Condensate Drain through a peristaltic pump.
- Clean the gas through a filter.
- Control device for residual humidity output.

Alarm Contact

The terminal block the reporting of failures is so configured:

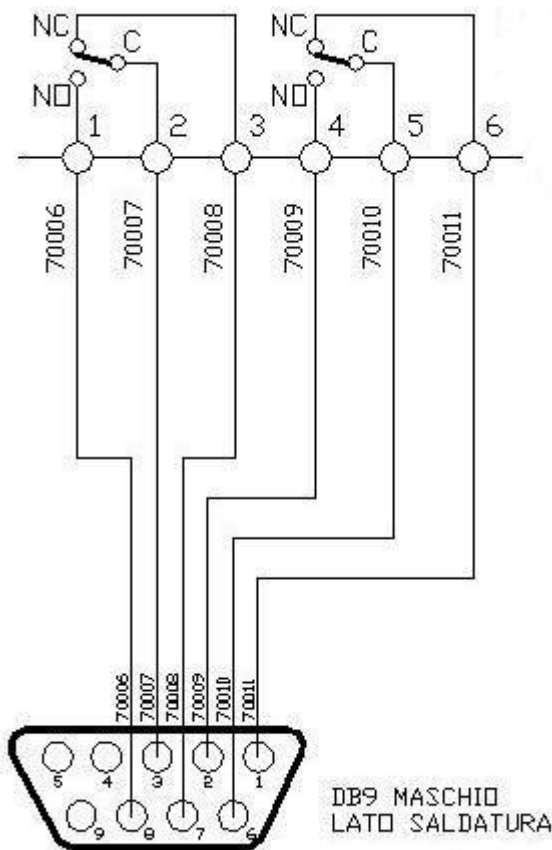

FREE CONTACT FOR ALARM CONDENSATE

PIN 3 COMMON CONTACT

PIN 8 NORMALLY OPEN

PIN 7 NORMALLY CLOSE

FREE CONTACT FOR ALARM CHILLER

PIN 6 COMMON CONTACT

PIN 2 NORMALLY OPEN

PIN 1 NORMALLY CLOSE

Dimension

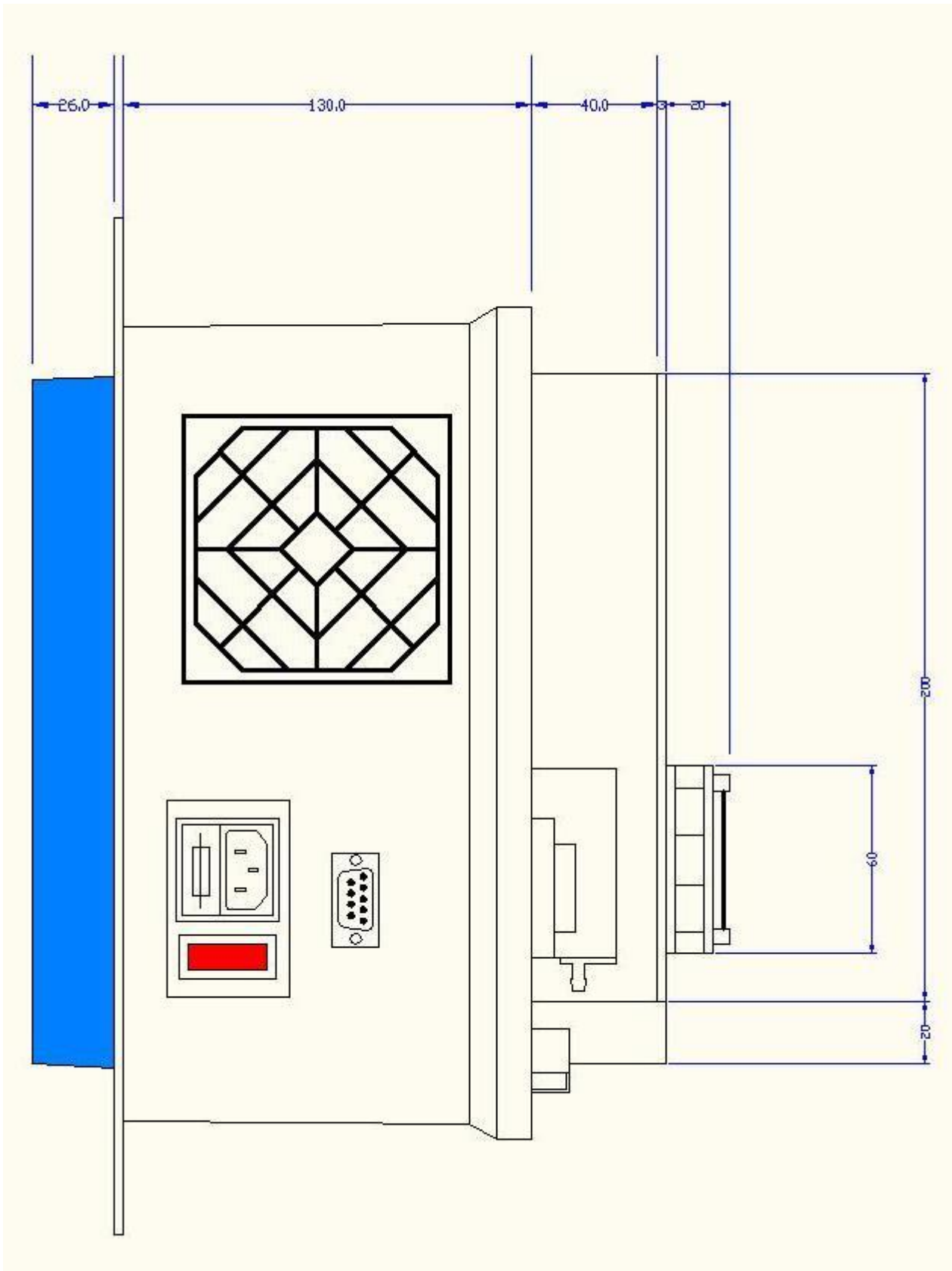

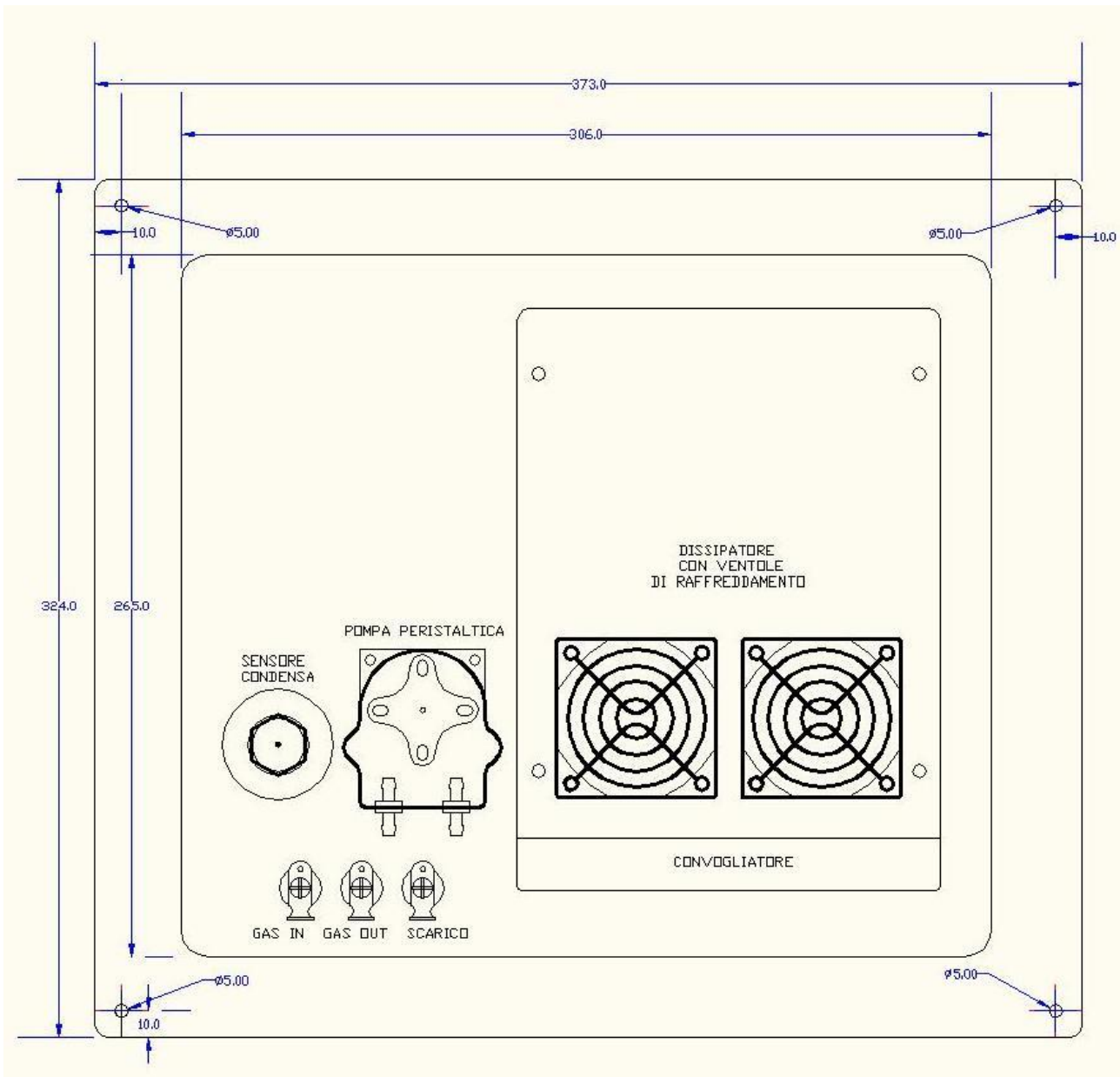

THECNICAL SPECIFICATION

| | |
|-----------------------|------------------|
| Operating temperature | 0 °C / 50 °C |
| Operating Pressure | -500 / +500 mBar |
| Weight | 8,5 Kg |
| Stabilization | < 0,1°C |